

Multiple Connectivity



Output

- 1 coax output 32KHz to 192KHz 16 to 24 bits (selectable on/off in menu)
- 1 optical output 32KHz to 96KHz 16 to 24 bits (selectable on/off in menu)
- 1 headphone output up to 4.5V RMS with volume control
- 1 line output, 2V RMS fixed or up to 4.5V RMS with volume control

Analogue Output

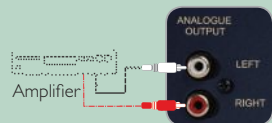

- 1) To connect to a power amplifier, set the volume level to "variable" in the DAC menu.
- 2) To connect to an integrated or pre-amplifier, set the volume level to "fixed" in the DAC menu.

Input

- 3 coax inputs 32KHz to 192KHz, 16 to 24 bits
- 2 optical inputs 32KHz to 96KHz, 16 to 24 bits
- 1 USB input, 96KHz 24 bits fixed

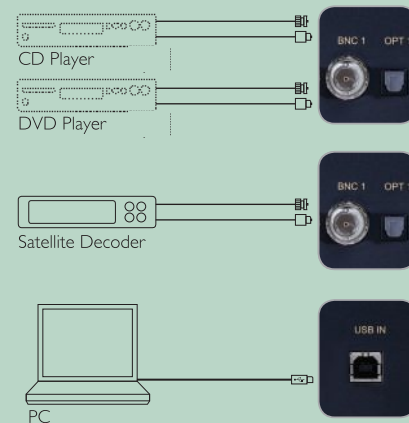

www.exposurehifi.com

Copyright 2011 Exposure Electronics Ltd

exposure
high fidelity engineering
since 1974

2010S2 DAC

Digital-to-Analogue Converter

Take your sound to the
next level...



A DAC (digital-to-analogue convertor) is a device that converts a binary digital signal code into an analogue signal. Put simply, it takes digital inputs from various digital audio sources and outputs audio signals to an amplifier. The better the signal, the better the sound.

The Exposure 2010S2 DAC has 6 digital inputs for hooking up to multiple digital audio sources, including CD players, DVD players, AV Processors, game consoles and PCs that are equipped with digital output ports. Hook it up to your favourite digital source and expose yourself to real hi-fi sound.

Exposure Electronics Ltd
Unit 18, Winston Business Centre, Chartwell Road,
Lancing, West Sussex, BN15 8TU,
United Kingdom.
Tel: +44 1273 423877 Fax: +44 1273 806648
www.exposurehifi.com

2010S2 DAC

Digital-to-Analogue Converter

TECHNICAL SPECIFICATIONS

Frequency Response	: 20Hz - 20Khz \pm 0.2dB
Total Harmonic Distortion	: <0.005% at 2V RMS 1KHz output
Signal to Noise Ratio	: >110dB ref 2V RMS output @ 1KHz
Channel Separation	: 20Hz - 20KHz, >60dB
Mains Supply (factory set)	: 110/120V or 220/240V, 50/60Hz
Power Consumption	: 20VA
Dimensions (H x W x D)	: 90 mm x 440 mm x 310 mm
Nett Weight (Unpacked)	: 5 kg
Gross Weight (Packed)	: 7 kg

SPECIAL FEATURES

1. Multiple stages of regulation for SPDIF input receiver, USB input, clock oscillator, DAC and output stage for accurate output.
2. Very clean master clock to SPDIF input receiver and USB input to ensure low jitter operation.
3. Discrete filter and output stage for optimum performance (no Op-Amp ICs).
4. Digital output can be switched "on" or "off" (and is re-timed) to reduce the jitter level as compared to SPDIF input. This function can also be used to convert USB input to SPDIF output.

“This being the digital age, we feel that there is a need for a quality DAC that delivers good sound from various sources. The 2010S2 DAC is the first of its kind from Exposure. It has been designed to deliver real hi-fi sound from compatible digital outputs. Give it a go – you will be surprised how good your music, movies or computer games can sound.”

Tony Brady, Chief Designer, Exposure Electronics Ltd.